

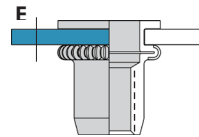

# GROOVED LARGE HEAD NUT TUERCA RANURADA CABEZA ANCHA

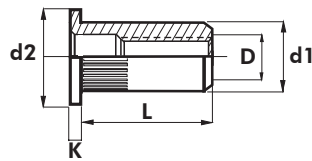

English	Español	Français	Deutsch	Portugues
Large head	Cabeza ancha	Tête large	Grosskopf	Cabeça larga
Grooved	Ranurada	Rainure	Mit schaffrändelung	Ranhurada
Open end	Fondo abierto	Fond ouvert	Offen	Fundo aberto
Steel * Zincplated A3K	Acero * cincado A3K	Acier * zingué A3K	Stahl * verzinkt A3K	Aço * zincado A3K

Steel /acero Qst 34.3 C8C D IN 1.0213

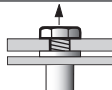
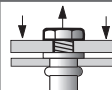
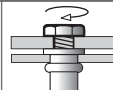

D	 MAX. E m/m	L Nominal m/m	d1 Ø m/m	d2 Ø m/m	K m/m		Part No./Ref.
M 3	0,25 - 2,00	10,50	4,90	8,00	1,00	5,10	0371103005
M 4	0,50 - 3,00	9,50	5,90	9,00	1,00	6,10	0371104006
	3,00 - 4,50	12,25					0371114006
M 5	0,50 - 3,00	12,00	6,90	10,00	1,00	7,10	0371105007
	3,00 - 5,50	15,00					0371115007
M 6	0,50 - 3,00	14,50	8,90	13,00	1,50	9,10	0371106009
	3,00 - 5,50	16,50					0371116009
	0,50 - 2,00	13,00					0371136009
M 8	0,50 - 3,00	16,50	10,90	16,00	1,50	11,10	0371108011
	3,00 - 5,50	18,50					0371118011
M 10	1,00 - 3,50	19,50	12,90	19,00	1,70	13,10	0371101013
	3,50 - 6,00	21,50					0371111013
	2,40 - 4,00	19,50					G371121013
M 12	1,00 - 4,00	25,00	15,90	23,00	2,00	16,10	G371101216

D	 Setting effort Fuerza para remachado	 Tensile Strength Threads Tracción	 Torque Testing Par de apriete
M 3	2400	4100	2,2
M 4	3900	7900	4,5
M 5	5100	12000	6,4
M 6	6000	20000	17,8
M 8	8400	29800	34,5
M10	11000	43300	60,0
M12	14700	47700	161,5

The total or partial reproduction of this document is prohibited. The figures showed in this catalogue are typical values and they could be changed as a result of the continuous improvement of products. Please, do not hesitate to contact us if you need an updated information. Queda prohibida la reproducción total o parcial de este documento. Los datos que aparecen en este catálogo son valores típicos y están sujetos a modificaciones como consecuencia de la mejora continua de los productos. Consúltenos si necesita información actualizada.